



Ravenswood Drive South, Solihull

Guide Price £400,000





PROPERTY OVERVIEW

Presenting a delightful three-bedroom detached family home offered with the advantage of NO UPWARD CHAIN and the freehold purchased upon completion. Nestled on a tranquil street in the sought-after area of Solihull, this residence boasts convenience being a short stroll from various local amenities and schools. Upon entering the property, one is greeted by the inviting hallway featuring a guest cloakroom. The spacious living room showcases double doors that lead out to the rear garden, while the fitted kitchen/diner bathes in natural light. Upstairs, the three generously proportioned bedrooms are serviced by a family bathroom.

Outside, a private south easterly facing rear garden provides a serene retreat, ideal for relaxation or entertaining. Completing this property is a driveway leading to a single garage, offering ample parking. This charming abode is poised to offer comfortable living in a prime location, making it an enticing opportunity for discerning buyers seeking a new family home.



PROPERTY LOCATION

Solihull offers an excellent range of amenities which includes the renowned Touchwood Shopping Centre, Tudor Grange Swimming Pool/Leisure Centre, Park and Athletics track. There is schooling to suit all age groups including Public and Private schools for both boys and girls, plus a range of services including commuter train services from Solihull Station to Birmingham (8 miles) and London Marylebone. In addition, the National Exhibition Centre, Birmingham International Airport and Railway Station are all within an approximate 10/15 minutes drive and the M42 provides fast links to the M1, M5, M6 and M40 motorways.

Council Tax band: D

Tenure: Leasehold

- Three Bedroom Detached Family Home
- FREEHOLD UPON COMPLETION
- NO UPWARD CHAIN
- Set On A Quiet Road In Solihull
- Spacious Living Room
- Fitted Kitchen / Diner
- Three Generously Sized Bedrooms
- Family Bathroom
- South Easterly Facing Rear Garden
- Driveway & Single Garage





HALLWAY

WC

LIVING ROOM

17' 8" x 11' 5" (5.38m x 3.48m)

KITCHEN/DINER

13' 1" x 12' 9" (3.99m x 3.89m)

FIRST FLOOR

BEDROOM ONE

9' 8" x 11' 4" (2.95m x 3.45m)

BEDROOM TWO

11' 1" x 9' 7" (3.38m x 2.92m)

BEDROOM THREE

7' 7" x 8' 3" (2.31m x 2.51m)

BATHROOM

6' 5" x 6' 2" (1.96m x 1.88m)

OUTSIDE THE PROPERTY

GARAGE

8' 0" x 17' 2" (2.44m x 5.23m)

TOTAL SQUARE FOOTAGE

95.0 sq.m (1027 sq.ft) approx.

DRIVEWAY PARKING

PRIVATE REAR GARDEN



ITEMS INCLUDED IN THE SALE

Free standing cooker, fridge, freezer, garden shed, greenhouse, all carpets, curtains, blinds and light fittings and fitted wardrobes in three bedrooms.

ADDITIONAL INFORMATION

Services - water on a meter, mains gas, electricity and sewers. Ground rent - currently - £45 pa. - will not be payable once freehold is purchased upon completion.

INFORMATION FOR POTENTIAL BUYERS

1. MONEY LAUNDERING REGULATIONS - Intending purchasers will be required to produce identification documentation at the point an offer is accepted as we are required to undertake anti-money laundering (AML) checks such that there is no delay in agreeing the sale. Charges apply per person for the AML checks. 2. These particulars do not constitute in any way an offer or contract for the sale of the property. 3. The measurements provided are supplied for guidance purposes only and potential buyers are advised to undertake their measurements before committing to any expense. 4. Xact Homes have not tested any apparatus, equipment, fixtures, fittings or services and it is the buyers interests to check the working condition of any appliances. 5. Xact Homes have not sought to verify the legal title of the property and the buyers must obtain verification from their solicitor.



Approx Gross Internal Area
95 sq m / 1027 sq ft



Ground Floor
Approx 55 sq m / 588 sq ft

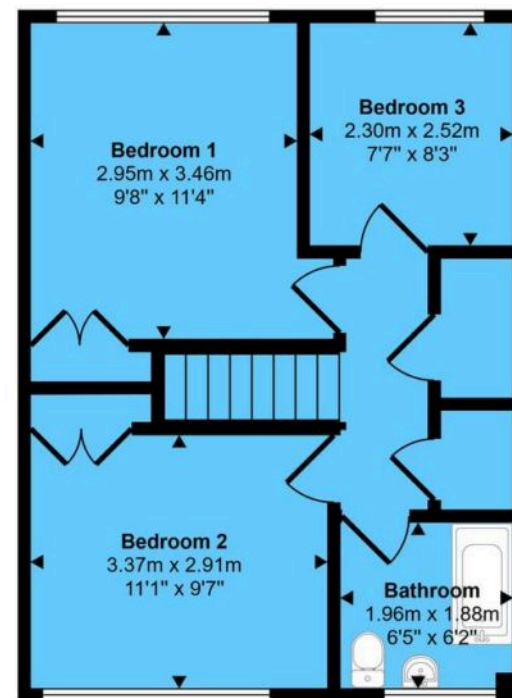

First Floor
Approx 41 sq m / 439 sq ft

This floorplan is only for illustrative purposes and is not to scale. Measurements of rooms, doors, windows, and any items are approximate and no responsibility is taken for any error, omission or mis-statement. Icons of items such as bathroom suites are representations only and may not look like the real items. Made with Made Snappy 360.

Xact Homes

6 The Square, Solihull - B91 3RB

0121 712 6222 • solihull@xacthomes.co.uk • www.xacthomes.co.uk

xact
HOMES

